



PROHEAT 2X[®] REVOLUTION[™] Deep Cleaner

USER GUIDE
1548, 1550 SERIES



More of a video person? Look for this icon and go online for an instructional how-to video at

www.BISSELL.com

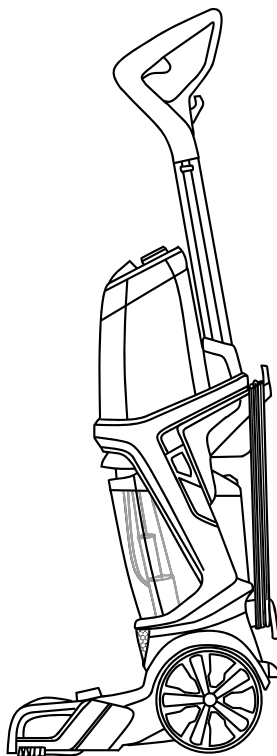
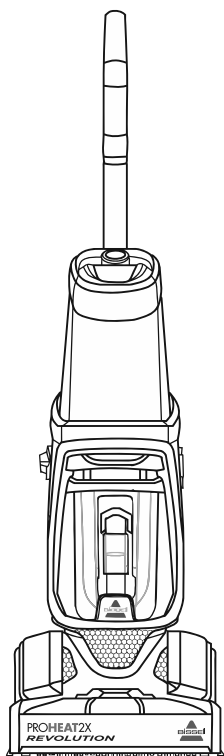

IMPORTANT SAFETY INSTRUCTIONS

READ ALL INSTRUCTIONS BEFORE USING YOUR DEEP CLEANER.

When using an electrical appliance, basic precautions should be observed, including the following:

WARNING

TO REDUCE THE RISK OF FIRE, ELECTRIC SHOCK OR INJURY:

- » Connect to a properly grounded outlet only. See grounding instructions. Do not modify the 3-prong grounded plug.
- » Do not leave appliance when it is plugged in. Unplug from outlet when not in use and before servicing.
- » Do not expose to rain. Store indoors.
- » Do not allow to be used as a toy. Close attention is necessary when used by or near children.
- » Do not use for any purpose other than described in this user guide. Use only manufacturer's recommended attachments.
- » Do not use with damaged cord or plug. If appliance is not working as it should, or has been dropped, damaged, left outdoors, or dropped into water, have it repaired at an authorized service center.
- » Do not pull or carry by cord, use cord as a handle, close a door on cord, or pull cord around sharp edges or corners.
- » Do not run appliance over cord. Keep cord away from heated surfaces.
- » Do not unplug by pulling on cord. To unplug, grasp the plug, not the cord.
- » Do not handle plug or appliance with wet hands.
- » Do not put any object into openings. Do not use with any opening blocked; keep openings free of dust, lint, hair, and anything that may reduce air flow.
- » Keep hair, loose clothing, fingers, and all parts of body away from openings and moving parts of the appliance and its accessories.
- » Turn OFF all controls before plugging or unplugging appliance.
- » Use extra care when cleaning on stairs.
- » Do not use to pick up flammable or combustible materials (lighter fluid, gasoline, kerosene, etc.) or use in areas where they may be present.
- » Do not use appliance in an enclosed space filled with vapors given off by oil-based paint, paint thinner, some moth-proofing substances, flammable dust, or other explosive or toxic vapors.
- » Do not use to pick up toxic material (chlorine bleach, ammonia, drain cleaner, etc.).
- » Do not pick up anything that is burning or smoking, such as cigarettes, matches or hot ashes.
- » Do not pick up hard or sharp objects such as glass, nails, screws, coins, etc.
- » Do not use without filters in place.
- » Use only BISSELL® cleaning formulas intended for use with this appliance to prevent internal component damage. See the "Cleaning Formulas" section of this guide.
- » Do not immerse. Use only on surfaces moistened by the cleaning process.
- » Keep appliance on a level surface.
- » Do not carry the appliance while in use.
- » Always install float before any wet pick-up operation.
- » Unplug before connecting TurboBrush® Tool.
- » Plastic film can be dangerous. To avoid danger of suffocation, keep away from children.
- » If your appliance has a motorized Brush Roll, do not leave machine running in the same spot without the handle fully upright.
- » Liquid must not be directed towards equipment containing electrical components.
- » Use only the type and amount of liquids specified under the operations section of this guide.
- » Use only on carpet moistened by cleaning process.

SAVE THESE INSTRUCTIONS FOR FUTURE USE

This model is for household use only. Commercial use of this unit voids the manufacturer's warranty.

WARNING

Improper connection of the equipment-grounding conductor can result in a risk of electrical shock. Check with a qualified electrician or service person if you aren't sure if the outlet is properly grounded. **DO NOT MODIFY THE PLUG.** If it will not fit the outlet, have a proper outlet installed by a qualified electrician. This appliance is designed for use on a nominal 120-volt circuit, and has a grounding attachment plug that looks like the plug in the illustration. Make certain that the appliance is connected to an outlet having the same configuration as the plug. No plug adapter should be used with this appliance.

GROUNDING INSTRUCTIONS

This appliance must be connected to a grounded wiring system. If it should malfunction or break down, grounding provides a safe path of least resistance for electrical current, reducing the risk of electrical shock. The cord for this appliance has an equipment-grounding conductor and a grounding plug. It must only be plugged into an outlet that is properly installed and grounded in accordance with all local codes and ordinances.

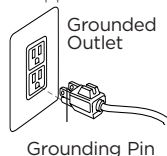

Thanks for buying a BISSELL®

ProHeat 2X® Revolution™ Deep Cleaner

We love to clean and we're excited to share one of our innovative products with you. We want your BISSELL ProHeat 2X Revolution to work like new for the years to come, so this guide has tips on how to use, maintain and, if there's a problem, troubleshoot.

Your BISSELL ProHeat 2X Revolution needs a little assembly before getting to work, so flip to the "Assembly" section and let's get started!

What's in the Box?

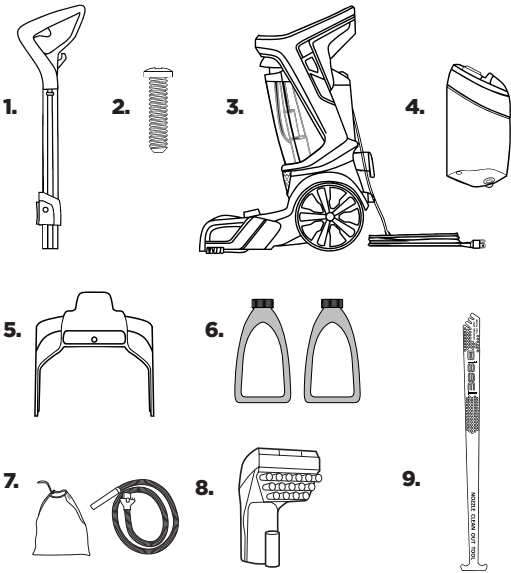

- 1. Upper Handle
- 2. 1 Screw attached to Upper Handle
- 3. Base with Dirty Water Tank
- 4. Clean Water Tank
- 5. Carry Handle
- 6. (2) Trial-Size Formulas
- 7. Accessory Bag & Hose
- 8. Attachments/Accessories (vary by model)
- 9. Nozzle Clean Out Tool

NOTE: Standard accessories may vary by model. To identify what should be included with your purchase, please refer to the "Carton Contents" list located on the carton top flap.

Safety Instructions.....	2	Troubleshooting	16
Product View.....	4	Warranty.....	17
Assembly	5	Service.....	17
Cleaning Formulas.....	6	Contact Information	17
Operations	7	Product Registration.....	20
Maintenance & Care	11	Parts & Supplies	20

Product View

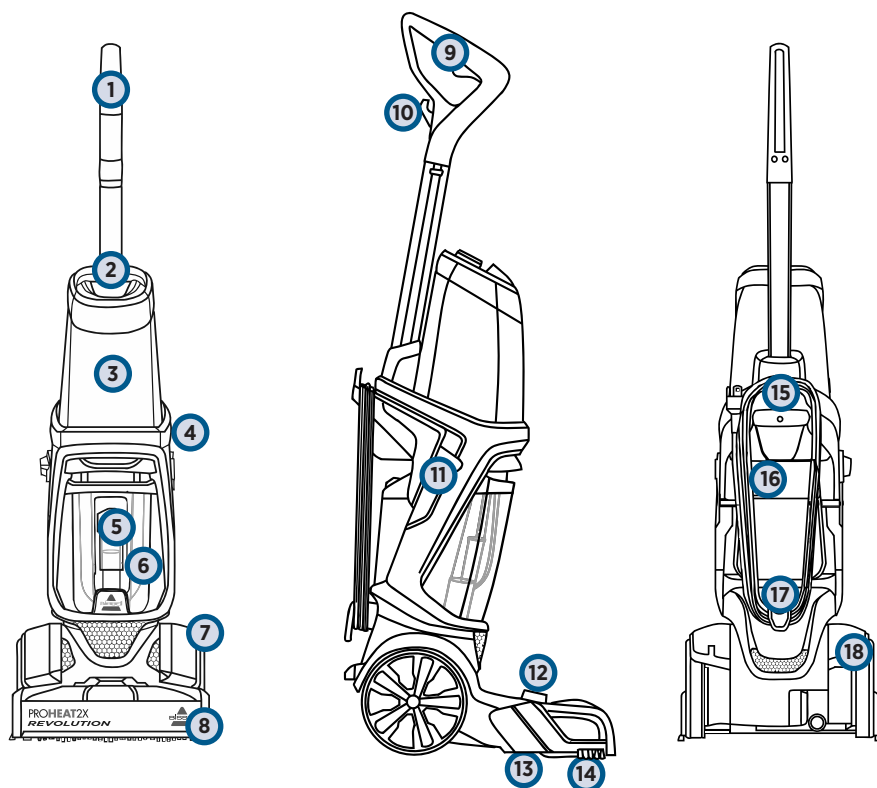

- | | | | |
|----|---|----|-------------------------------------|
| 1 | Upper Handle | 11 | Cleaning Mode Switch |
| 2 | Easy Fill/Formula Cap | 12 | Accessory Hose Door |
| 3 | Clean Water Tank
(1 Gallon Capacity) | 13 | Belt/Brush Access Plate |
| 4 | Power Switch | 14 | EdgeSweep® Brushes |
| 5 | Float Stack | 15 | Carry Handle |
| 6 | Dirty Water Tank | 16 | Rubber Tab
(on Dirty Water Tank) |
| 7 | Belt Access Door | 17 | Quick Release™ Cord Wrap |
| 8 | Foot | 18 | Recline Pedal |
| 9 | Spray Trigger | | |
| 10 | In-Use Cord Clip | | |

Assembly

WARNING

Do not plug in your deep cleaner until you are familiar with all instructions and operating procedures.

Your deep cleaner comes in four easy-to-assemble components and an accessory bag.

- Base
- Upper Handle
- Clean Water Tank
- Carry Handle

In Step 3 you will need a Phillips-head screwdriver.

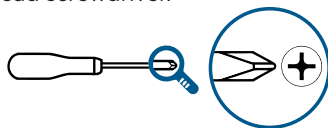

1

First, insert the Upper Handle at the top of the base until you hear a “click”.

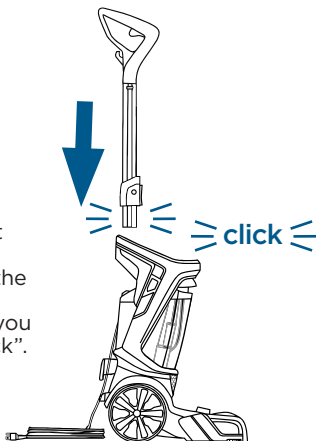

2

Side View

Next, align the Carry Handle with the slots on either side of the base (behind the Power Switch and Cleaning Mode Switch). The Carry Handle will “click” into place.

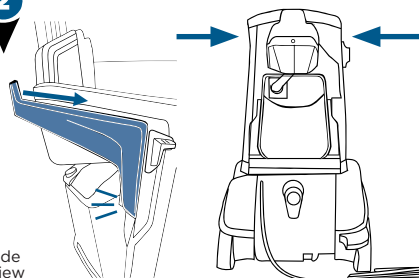

3

Using a Phillips-head screwdriver, secure the Carry Handle and the Upper Handle with the screw that's taped to the Upper Handle.

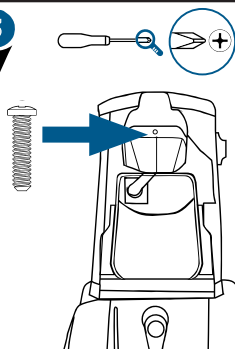

4

Wrap the cord around the Carry Handle and Quick Release™ Cord Wrap.

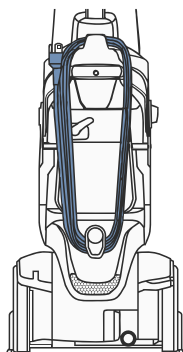

5

At the bottom of the Upper Handle, align the Clean Water Tank with the grooves and slide the tank into place.

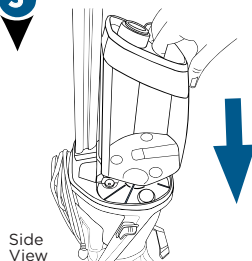

Cleaning Formula

⚠ WARNING

To reduce the risk of fire and electric shock due to internal component damage, use only BISSELL cleaning formula intended for use with this machine.

Keep plenty of BISSELL® cleaning formulas on hand so you can clean whenever it fits your schedule.

NOTE: Always use genuine BISSELL cleaning formulas for portable carpet and upholstery cleaners in your machine.

				
Clean + Refresh Powerful cleaning and odor elimination with Febreze freshness	PET Stain & Odor Removes tough pet stains <i>Includes StainProtect™ to protect against future stains</i>	PRO MAX Clean + Protect Our most powerful formula for tough, ground-in dirt & stains <i>Includes StainProtect to protect against future stains</i>	PET PRO OXY Urine Eliminator Our best formula for pet urine stains & odors <i>Includes StainProtect to protect against future stains</i>	Pet Stain & Odor + Antibacterial Cleans and controls odor causing bacteria <i>Use with easy fill® SYSTEM™</i>

Certain trademarks used under license from The Procter & Gamble Company or its affiliates.

Pretreat

Pretreat spots and stains to improve carpet cleaning performance.

		
PET Stain Pretreat Permanently removes tough pet stains & odors with Enzyme Action	PET PRO OXY Stain Destroyer Permanently removes tough pet stains & odors with OXY	PET Pretreat + Sanitize Penetrates to sanitize and loosen tough stains

Boost

Add Boost carpet cleaning formula enhancers to any formula to increase its effectiveness.

		
OXY Boost Removes old, set-in stains permanently	PRO MAX Boost Add to formula for 2X deep cleaning power	PET OXY Boost Removes pet stains and odors permanently

Filling Your Clean Water Tank

easyfill[®] formula SYSTEM™

1

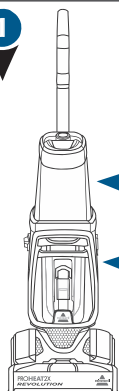

Clean Water Tank
(1 Gallon)

Dirty Water Tank

The Clean Water Tank is at the top of the machine.

2

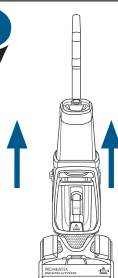

Lift the Clean Water Tank straight up to remove from the machine.

3

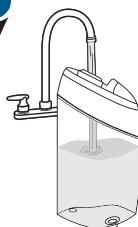

Unscrew the cap from the Clean Water Tank. Add hot tap water to the water fill line.

4

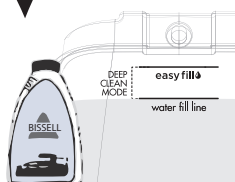

With Trial-Size Antibacterial Formula: Pour into the Clean Water Tank up to the EasyFill line. Twist the cap back onto the tank.

5

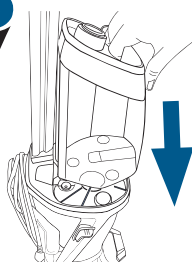

At the bottom of the Upper Handle, align the Clean Water Tank with the grooves and slide the tank into place.

For Future Use with Full Size Antibacterial Formula:

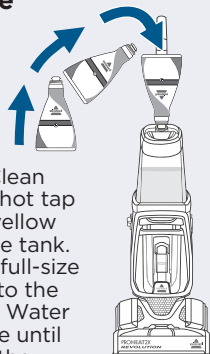

After filling the Clean Water Tank with hot tap water, twist the yellow cap back onto the tank. Firmly insert the full-size formula bottle into the cap on the Clean Water Tank and squeeze until formula reaches the EasyFill line.

A few notes about filling the Clean Water Tank:

- » Fill with hot (140°F/60°C MAX) tap water and add the appropriate BISSELL® formula. **DO NOT USE BOILING WATER. DO NOT HEAT WATER OR TANK IN MICROWAVE.**
- » When using BISSELL Deep Clean + Antibacterial formula: Only fill your Clean Water Tank with the recommended amount of water and formula to achieve antibacterial benefits.

NOTICE

BISSELL Deep Clean + Antibacterial formula is only for BISSELL machines with EasyFill System.

ATTENTION

Do not overwet carpet. Be careful not to run over loose objects or edges of area rugs. Stalling the brush may result in premature belt failure.

Filling Your Clean Water Tank (cont.)

BISSELL® Formula

1

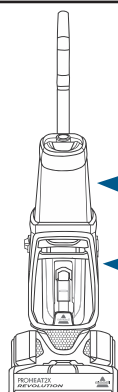

Clean Water Tank
(1 Gallon)

Dirty Water Tank

The Clean Water Tank is at the top of the machine.

2

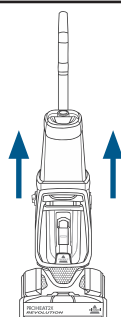

Lift the Clean Water Tank straight up to remove from the machine.

3

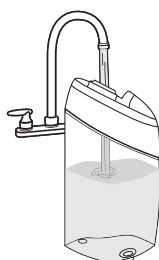

Unscrew the cap from the Clean Water Tank. Add hot tap water to the water fill line. Next, reference the chart below for formula amounts to add to the tank. Twist cap back into place.

4

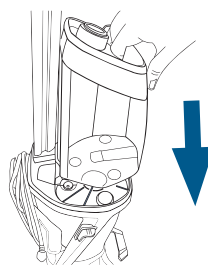

At the bottom of the Upper Handle, align the Clean Water Tank with the grooves and slide the tank into place.

FORMULA FILLING INSTRUCTIONS

DEEP CLEAN MODE

EXPRESS CLEAN MODE

BISSELL Formulas

Fill water to the Water Fill Line, then add 2.5 oz of formula.

Fill water to the Water Fill Line, then add 1.25 oz of formula.

NOTE: Fill with hot (140°F/60°C MAX) tap water and add the appropriate BISSELL formula. **DO NOT USE BOILING WATER. DO NOT HEAT WATER OR TANK IN MICROWAVE.** Do not substitute BISSELL Formula with other household cleaning products.



Pour in more power with BISSELL Boosts

- » Fill tank with water and formula (step 3 above).
- » Add 2 ounces of any BISSELL Boost per 1 gallon of water.
- » The ProHeat 2X® Revolution™ has a 1-gallon Clean Water Tank.

Cleaning Your Carpet

1

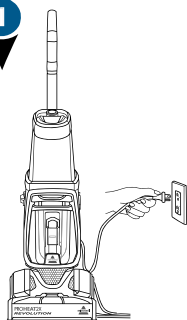

Plug into a properly grounded outlet.

2

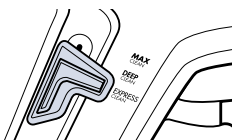

Select Cleaning Mode

Max Clean

- » Provides a heavy cleaning for your dirtiest carpets.
- » Dry Time: About 8 hours.

Deep Clean

- » Delivers a deep clean to your carpet.

Express Clean

- » Provides a lighter clean.
- » Dry Time: About 30 minutes.
- » Recommended Cleaning Pace: 12 inches per second

3

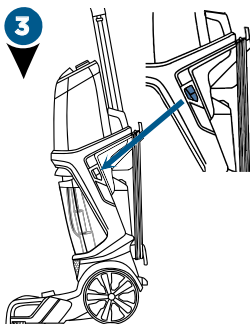

Press the Power Switch to turn the machine ON. To recline your machine for use, press the Recline Pedal with your foot.

4

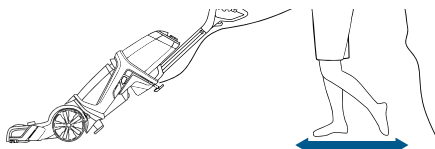

Max Clean & Deep Clean Modes:

Standard Cleaning

1. Press the Spray Trigger to apply solution while making 2 slow, wet passes (1 forward, 1 back).
2. Release the Spray Trigger.
3. Make 2 slow, dry passes (1 forward, 1 back) to suck up the dirty solution.
Do not hold down the trigger for this step.

Using BISSELL® Deep Clean + Antibacterial Formula

1. Press the Spray Trigger to apply solution while making 3 slow, wet passes (1 forward, 1 back and 1 forward again).
2. Release the trigger.
3. Make 1 slow, dry pass back to suck up the dirty solution. **Do not hold down the trigger for this step.**

Express Clean Mode:

Recommended Cleaning Pace: 12 inches per second

1. Press the Spray Trigger to apply solution while making 2 wet passes (1 forward, 1 back).
2. Release the Spray Trigger.
3. Make 2 dry passes (1 forward, 1 back) to suck up the dirty solution.
Do not hold down the trigger for this step.

CLEANING TIPS:

- » To prevent damage to Berber carpets, avoid repeated strokes in the same area.
- » For best cleaning performance, clean with your machine in Deep Clean Mode.
- » Choose Deep Clean Mode and use BISSELL Deep Clean + Antibacterial to deliver antibacterial benefits.
- » In Max Clean Mode dry time is an estimated 8 hours. To expedite the drying process, place a fan in the room or near the carpet.
- » In Express Clean Mode, the Dirty Water Tank will not get as full as when cleaning with Deep or Max Clean Mode.
- » It is common to refill the Clean Water Tank and empty the Dirty Water Tank multiple times during the cleaning process. Room size and the speed at which you clean both affect how often the tank may need to be refilled and/or emptied.

Cleaning Area Rugs

IMPORTANT: Please check manufacturer's tag before cleaning area rugs for any specialized cleaning instructions. We do not recommend deep cleaning delicate, silk, wool, antique, or area rugs without a manufacturer's tag.

Regularly clean your high-traffic area rugs in Express Clean Mode:

- » Check the manufacturer's tag.
- » Select Express Clean Mode.
- » When cleaning area rugs, place the rug on a sealed surface to test for colorfastness in an inconspicuous area. Your cleaner should not be used on unsealed surfaces.
- » Important: Keep the Foot of the deep cleaner perpendicular to the rug's edge with each cleaning pass to prevent damage.

Cleaning with Hose and Tool

- » Keep hair, loose clothing, fingers, and all parts of body away from openings and moving parts. The Brush Roll continues to rotate when in the upright position.
- » The Brush Roll continues to turn while product is turned ON and handle is in upright position. To avoid damage to carpet, rugs, furniture, and flooring, avoid tipping cleaner or setting it on furniture, fringed area rugs or carpeted stairs during tool use.
- » With Brush Roll on, do not allow cleaner to sit in one location for an extended period of time, as damage to floor can result.

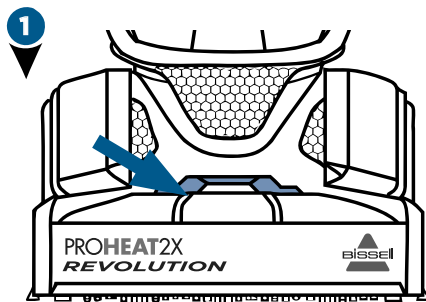

Lift the Accessory Hose Door on top of foot on the front of the machine. The door flips toward the machine to open.

- 2** Insert the hose and snap into place. Be sure the colored hose release clip is facing out, away from machine.

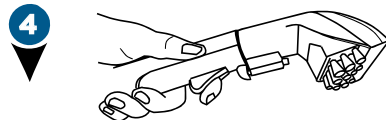

Press the Spray Trigger button to spray the soiled area, then slowly move tool back and forth over the area.

Release the trigger to suck up the dirty solution. Work in small sections until the area is clean.

When finished cleaning, turn the machine ON to suction up warm clean water to rinse the inside of the hose and tool. Detach the hose and tool and close the Accessory Hose Door. Let the hose and tool air dry before storing.

- 3** Attach the tool to the end of the hose. (Tools may vary by model.) Press the Power Switch to turn machine ON.

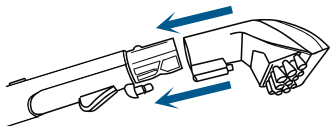

NOTE: If using the **Mini Deep Reach Tool**, be sure the needles of the tool are pressed down into the carpet so the spray gets into the carpet fibers.

Emptying the Dirty Water Tank

WARNING

To reduce the risk of fire, electric shock or injury, turn power OFF and disconnect plug from electrical outlet before performing maintenance or troubleshooting.

1

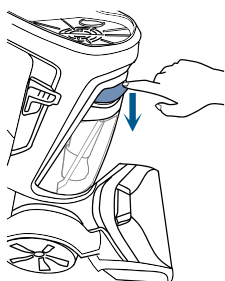

To release Dirty Water Tank, press down on the colored tank handle.

2

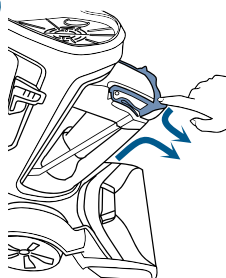

Tilt the tank slightly toward you. Grab the handle and tank with both hands.

3

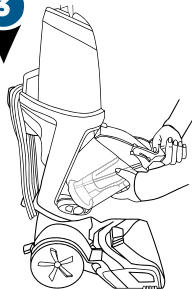

Pull Dirty Water Tank up and away to remove.

4

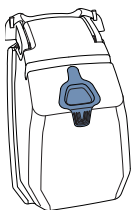

For quick empty:

Pull the Rubber Tab (located in the middle of the tank) and tilt to pour.

When closing the Rubber Tab, make sure all edges are sealed tight.

5

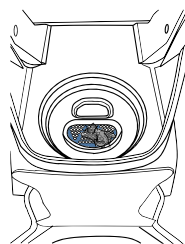

Clean the red filter below the Dirty Water Tank by wiping off any remaining dirt or debris.

6

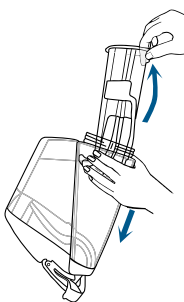

For final clean and rinse:

Unscrew the ring at the bottom of tank.

Gently remove the Float Stack, rinse, and clean.

Once clean, return Float Stack into the tank by lining up the arrows so they point at each other. This is the only way the Float Stack will fit into the tank.

With the arrows aligned, the Float Stack should lock into place.

Return the ring and twist to lock. Water may leak if the ring is not fully tightened.

To return the Dirty Water Tank:

Angle the tank and insert bottom first. Then tilt the tank toward the machine and push the top in until it clicks into place.

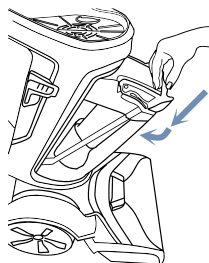

Did You Know?

The Float Stack is what prevents your Dirty Water Tank from overflowing.

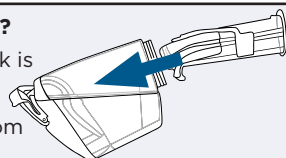

Cleaning Machine After Use

⚠ WARNING

To reduce the risk of fire, electric shock or injury, turn power OFF and disconnect plug from electrical outlet before performing maintenance or troubleshooting.

1



Rinse the Clean Water Tank with warm tap water. Fill the tank with warm tap water, twist the cap on and return the tank to the machine. Twist cap back on tightly.

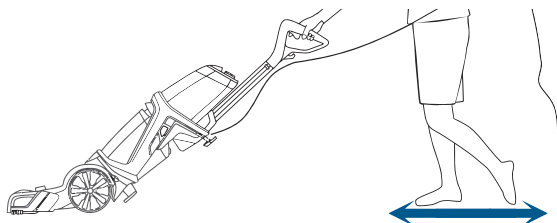

To flush and rinse machine turn it ON and press the Spray Trigger for 15 seconds while making forward and backward passes on carpet. Release the trigger and suck up water.

See page 11 to clean the Dirty Water Tank from the water that was just sucked up. Empty the Clean Water Tank and let dry before storing. Wipe your machine's exterior with a soft cloth.

NOTE: Be sure to clean the Brush Rolls and nozzle before storing your machine. Follow these steps if your nozzle becomes clogged with hair or debris.

NOTICE To reduce the risk of a leaking condition, do not store unit where freezing may occur. Damage to internal components may result.

Cleaning the Nozzle

1

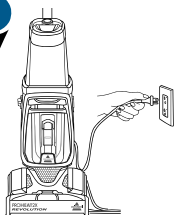

If pet hair or debris become clogged in the nozzle, it can be cleaned out of the nozzle with the Nozzle Clean Out Tool.

Turn OFF and unplug the machine.

2

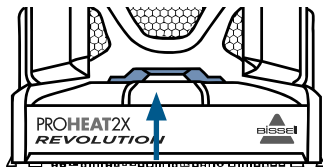

Remove the nozzle from the Foot: flip the Accessory Hose Door open and lift up on the nozzle and Accessory Hose Door.

3

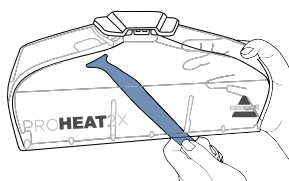

Hold the nozzle and insert the Nozzle Clean Out Tool into the thin slot at the front of the nozzle where it touches the floor. Clean until free of pet hair or debris.

4

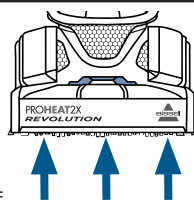

Return the nozzle back to the foot of the machine. Line up the three hooks on the nozzle to the bottom of the foot (see arrows for location).

Rotate the nozzle up and click into place. Close the Accessory Hose Door.

Cleaning the Brush Rolls

1

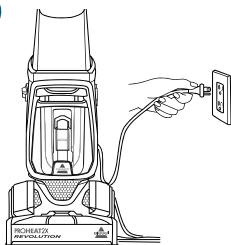

Turn OFF and unplug the machine.

2

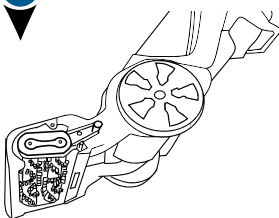

Lay the machine down on its back or side.

3

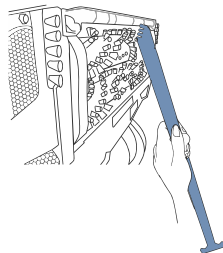

Use the comb to brush out the debris or hair from the Brush Rolls.

Replacing Belts or Brush Rolls

What you will need: 1 Phillips-head screwdriver & 1 flathead screwdriver

1

Unplug the machine. Remove both tanks from the machine. Press the Recline Pedal and lay the machine on its back. Use a flathead screwdriver to help lift and remove the Belt Access Door.

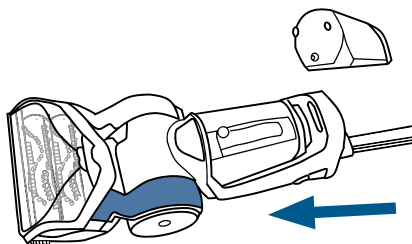

2

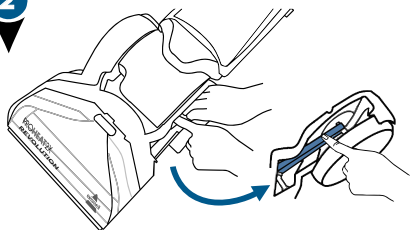

Here you should see one (1) belt. This is the flat pump belt. If this belt is broken, gently remove it from the machine. We will replace this belt in Step 5.

3

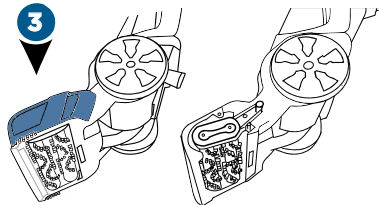

Turn the machine on its side. The Power Switch should be facing up. Remove the 3 screws on the Belt/Brush Access Plate using a Phillips-head screwdriver. Remove the access plate to expose the brush cover and cogged large pump belt.

4

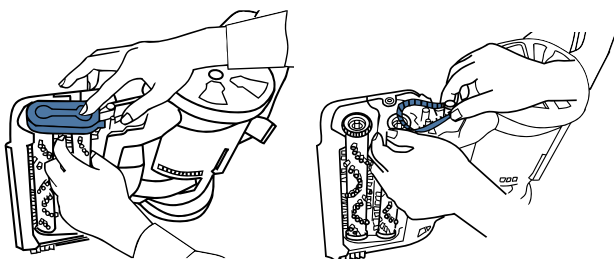

Remove the brush cover by lifting straight up. Remove the cogged large pump belt. The Brush Rolls can be replaced or cleaned at this time, if needed.

Replacing Belts or Brush Rolls (cont.)

5

If the flat pump belt was broken, place a new belt around the red area of the large pulley. Then use your thumb to stretch it toward the back of the machine and transfer it onto the metal axle.

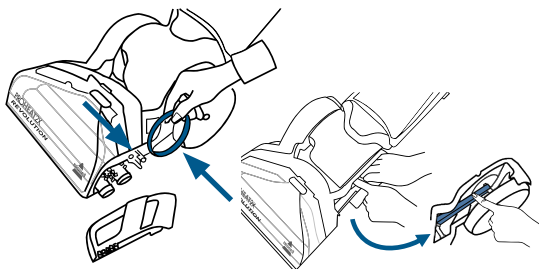

6

Spin either brush. If they both spin, continue to Step 7.

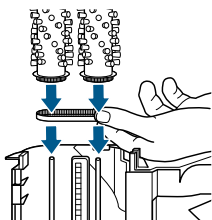

If only one spins, the opposite belt is broken and you must remove both brushes and replace the small cogged brush belt.

Place the new belt around both brush gears and slide them onto the thin metal axles.

7

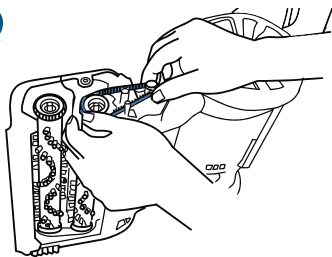

To replace the cogged large pump belt, make sure your deep cleaner is completely reclined. Begin by wrapping the cogged large pump belt around the small metal-toothed pulley. While wrapped around the pulley, stretch and wrap around the nearest brush gear.

8

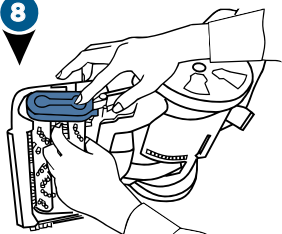

Return the brush cover. Make sure that the brushes are aligned and the cover is secure.

9

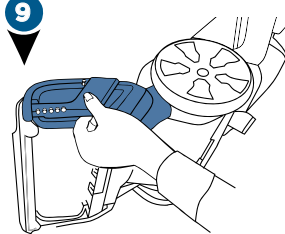

Return the Belt/Brush Access Plate to the end of the Brush Rolls by securing with the 3 screws.

10

Turn the machine to lay on its back.

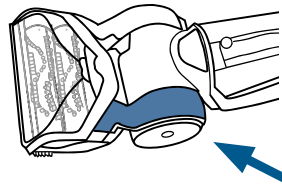

Lastly, slide the Belt Access Door back into place. You should hear it "click" into place.

Troubleshooting

WARNING

To reduce the risk of electric shock, turn OFF and disconnect plug from electrical outlet before performing maintenance or troubleshooting checks.

Problem	Possible causes	Remedies
Reduced spray OR no spray	Clean Water Tank may be empty.	Refill tank.
	Clean Water Tank may not be seated completely.	Turn power OFF. Remove and reseal tank.
	Pump may have lost prime in Hose Cleaning Mode.	Hold end of hose below water level in tank to prime.
No spray through hose & tool	The hose to your machine is not primed.	With the machine OFF and unplugged, remove the nozzle from the foot. Place a ballpoint pen in the black cylinder next to the screw. When water bubbles up, remove the pen. Reassemble the nozzle and hose.
Loss of suction power	Tanks may not be seated properly.	Pick up both tanks and reseal them so they fit properly on the unit.
	Dirty Water Tank has picked up maximum amount of dirty water and has reached full line.	Empty Dirty Water Tank.
	Clean Water Tank is empty.	Check fluid levels in the Clean Water Tank. Refill the tank if it is empty.
	Rubber Tab on Dirty Water Tank is not sealed tight.	Check the Rubber Tab on the Dirty Water Tank and press firmly on all edges to secure it tightly (see step 4 on page 11 for details).
	Accessory Hose Door may not be closed tightly in place.	Check the Accessory Hose Door and make sure it is closed tightly – it should be locked into place.
	Nozzle may be clogged from pet hair or debris.	Use the Nozzle Clean Out Tool and follow steps on page 13 for “Cleaning Nozzle”.
No power	Cleaning Mode switch mistaken for Power Switch.	Press the Power Switch on the left side of the machine to turn the machine ON.
	Outlet may not be active.	Try plugging in a different device that uses a grounded outlet to test for power from the outlet.
Leaking tank	Tank may have been over-filled.	1. Make sure your tank has the water and formula in it that you’ve prepared.
	Water may be caught in space between the tank and the tank’s handle.	2. With the cap twisted ON tightly, hold your tank at an angle, over a sink or drain, so any extra water can pour out of the space. 3. Wipe the tank dry with a cloth.

Warranty

This warranty gives you specific legal rights, and you may also have other rights which may vary from state to state. If you need additional instruction regarding this warranty or have questions regarding what it may cover, please contact BISSELL Consumer Care by E-mail or telephone as described below.

It may be necessary to obtain some of your personal information, such as a mailing address, to fulfill terms of this warranty. Any personal data will be handled pursuant to BISSELL's Privacy Policy, which can be found online at www.BISSELL.com/privacy-policy.

Limited Three-Year Warranty

Subject to the ***Exceptions and Exclusions from the Terms of the Limited Warranty**, upon receipt of the product BISSELL will repair or replace (with new, refurbished, lightly used, or remanufactured components or products), at BISSELL's option, free of charge from the date of purchase by the original purchaser, for three years, any defective or malfunctioning part.

See information below on "If your BISSELL product should require service".

This warranty applies to product used for personal, and not commercial or rental, service. This warranty does not apply to fans or routine maintenance components such as filters, belts or brushes. Damage or

malfunction caused by negligence, abuse, neglect, unauthorized repair, or any other use not in accordance with the user guide is not covered. This warranty will only be valid if the product is used in the same country in which it was sold.

BISSELL is not liable for incidental or consequential damages of any nature associated with the use of this product. BISSELL's liability will not exceed the purchase price of the product.

Some states do not allow the exclusion or limitation of incidental or consequential damages, so the above limitation or exclusion may not apply to you.

*Exceptions and Exclusions from the Terms of the Limited Warranty

This warranty is exclusive and in lieu of any other warranties, either oral or written. Any implied warranties, which may arise by operation of law, including the implied warranties of merchantability and fitness for a particular purpose, are limited to the three-year duration from the date of purchase as described above.

Some states do not allow limitations on how long an implied warranty lasts, so the above limitation may not apply to you.

NOTE: Please keep your original sales receipt. It provides proof of date of purchase in the event of a warranty claim.

Service

Please do not return this product to the store.

Other maintenance or service not included in the manual should be performed by an authorized service representative.

If your BISSELL® product should require service:

Contact BISSELL Consumer Care to locate a BISSELL Authorized Service Center in your area. If you need information about repairs or replacement parts, or if you have questions about your warranty, contact BISSELL Consumer Care.

Website:

www.BISSELL.com/service-centers

E-mail:

www.BISSELL.com/email-us

Call:

BISSELL Consumer Care
1-800-237-7691

Notes

Notes

Register your product today!

Registering is quick, easy and offers you benefits over the lifetime of your product. You'll receive:

BISSELL® Rewards Points

Automatically earn points for discounts and free shipping on future purchases.

Faster Service

Supplying your information now saves you time should you need to contact us with questions regarding your product.

Product Support Reminders and Alerts

We'll contact you with any important product maintenance reminders and alerts.

Special Promotions

Optional: Register your email to receive notice of offers, contests, cleaning tips, and more!

Visit BISSELL.com/registration!

Parts & Supplies

For Parts and Supplies, go to www.BISSELL.com and enter your model number in the search field.

We're Waggin' Our Tails!

BISSELL® proudly supports BISSELL Pet Foundation® and its mission to help save homeless pets. When you buy a BISSELL product, you help save pets, too. We're proud to design products that help make pet messes, odors and pet homelessness disappear.

Visit **BISSELLsavespets.com** to learn more.



Love your **BISSELL®** product?

Don't keep it a secret.
Let us, and millions of others, know what you think!
Leave your star-rating on BISSELL.com

www.BISSELL.com



©2020 BISSELL Inc. All rights reserved.
Printed in China. Part Number 1623380 01/20 RevD